

Spider Climbing Hexagon 4226EPZ

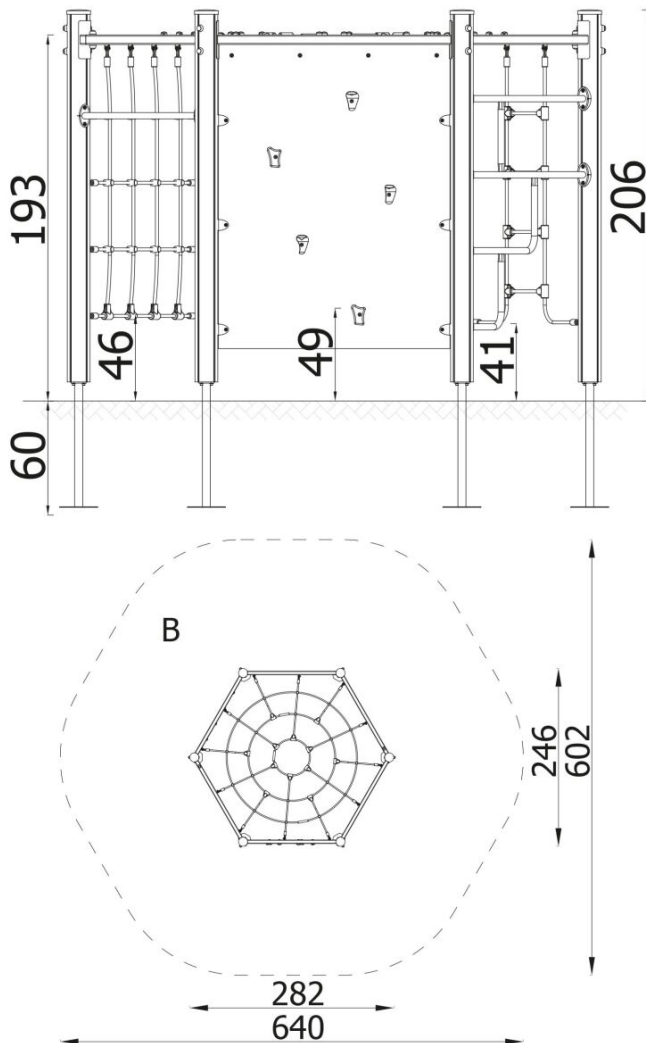
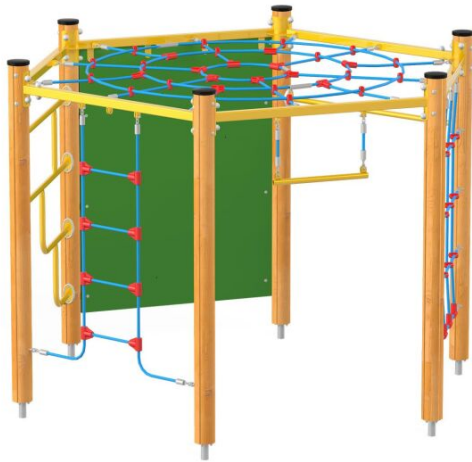

DESCRIPTION

Climbing device which children are eager to use during playing. Overcoming the device and attempting to move from one side to another activate child's motor development, muscle performance and strength. The ladder is perfect for school and local playgrounds.

INFORMATION

Number of users	12
Age range	3 - 14
Device dimensions [m]	2.82 x 2.06 x 2.46
Compliance with the norm	EN-1176-1:2017-12
Spare parts	

SAFETY SURFACE

Zone	Max height of fall [m]	Area [m ²]	Perimeter of safety zone [m]
A			20
B	1.93	30.5	
C			